

Single-Acting, Spring Return, Pull Cylinders

CMT Series

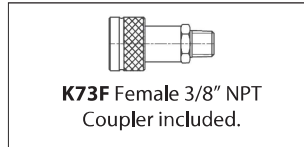
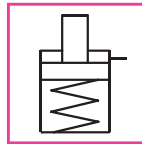

Capacity:
2 - 60 tonnes

Stroke:
127 - 150 mm

Maximum Operating Pressure:
700 bar (10,000 psi)

CMT## N ###

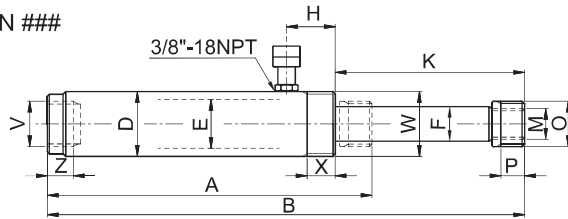

ZAS set of devis eyes available for 'N' version. Refer Page: 23

CMT## L ###

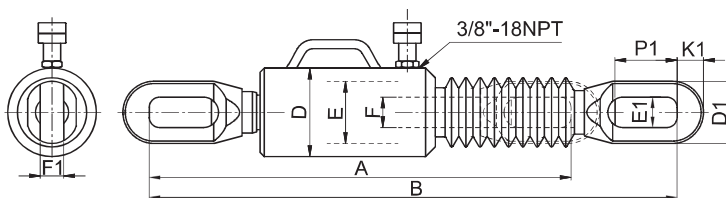

Designed for pulling and tensioning

Steel 'N' version:-

- Available in 2, 5 & 10 tonnes models designed with threads on the cylinder body, piston rod & in the cylinder internal base to mount proper accessories.
- The internal & external nitriding treatment provides good corrosion & wear resistance.
- Used in assembling, building & in laboratories to test the resistance of materials.

Aluminium 'L' version:-

- Available in 10, 30 & 60 tonnes models.
- Designed completely in aluminium (except the piston rod).
- Anodizing treatment protects cylinders against corrosion.
- Equipped with a bellow to protect the piston rod.
- Carrying handle for 30 tonnes & above models.
- Used in shipbuilding & in steel structural works to pull plates or prefabricated parts together for welding.

STEEL CYLINDERS SELECTION CHART

Force (PULL) Tonnes (kN)	Stroke mm	Effective Area (PULL) cm ²	Oil Volume cm ³	MODEL	Closed Height	Extended Height	Outside Dia.	Bore Dia.	Piston Rod Dia.	Coupler Distance	Rod Protrusion	Rod Thread	Saddle Thread	Saddle Thread Length	Internal Base Thread	Internal Base Thread Length	Body Thread/ Thread Length	Weight
					A mm	B mm	D mm	E mm	F mm	H mm	K mm	M mm	O mm	P mm	V mm	Z mm	W/X mm	kg
2 (22,9)	127	3,27	41	CMT2N127	244	371	48	30	22	39	155	M18x1,5	3/4" NPT	18	3/4" NP	20	M40x1,5 20	2,9
5 (55)	140	7,86	110	CMT5N140	301	441	60	45	32	45	175	M30x2	1 1/4" NPT	22	1 1/4" NPT	24	M60x1,5 26	4,9
10 (110)	150	15,71	236	CMT10N150	302	452	80	55	32	39	189	M30x2	-	30	M30x2	25	M80x2 20	8,0

Nominal value shown in 'Tonnes', see kN for the exact force @ 700 bar,

ALUMINIUM CYLINDERS SELECTION CHART

Force (PULL) Tonnes (kN)	Stroke mm	Effective Area (PULL) cm ²	Oil Volume cm ³	MODEL	Closed Height	Extended Height	Outside Dia.	Bore Dia.	Piston Rod Dia.	Eyelet Width	Slit Width	Eyelet Thickness	Eyelet Top Thickness	Slit Length	Weight
					A mm	B mm	D mm	E mm	F mm	D1 mm	E1 mm	F1 mm	K1 mm	P1 mm	kg
10 (110)	150	15,71	236	CMT10L150	526	676	75	55	32	55	32	20	20	100	4,4
30 (334)		47,71	716	CMT30L150	612	762	128	90	45	90	44	34	38	100	13,2
60 (559)		79,86	1199	CMT60L150	734	884	168	120	65	107	61	40	50	140	33,5

Nominal value shown in 'Tonnes', see kN for the exact force @700bar.